



ETHERNET CONTROL SYSTEMS

INPUT / OUTPUT CONTROLLER



Overview

The ECON Input / Output Controller (IOC) combines eight inputs and eight outputs in one convenient package. It is perfect for applications where a limited amount of general purpose I/O is required. The IOC is available in a 1 RU format that fits easily in open frame or enclosed data racks as well as a panel mount version for use in wall mount enclosures. Both formats allow installers to easily access the wiring connections on both the front and rear panels. The rack mount format also affords installers the use of standard 19" rack wire management hardware.

Control

The IOC provides 8 form C relay outputs and 8 sourcing inputs which can be set to require either a N.O. or N.C. connection for normal status. Each output includes a terminal for Relay common, a N.O terminal and a N.C. terminal. Each input includes a +24 vdc output and a status input for monitoring. Like all ECON I/O, the IOC allows users to associate any input in the system with any output.

Management

The IOC includes an LCD display to that shows device information such as IP address, subnet mask, gateway etc. as well as the status of each input and output.

The IOC can be easily configured using the ECON Configuration utility or through the embedded web server. Users can edit network settings, monitor input and output status and view or edit other controller parameters.

Communication

The IOC utilizes industry standard 802.3u fast Ethernet for control communication. Like all ECON controllers, the IOC utilizes a highly secure encryption algorithm to guard against unauthorized control or monitoring. The IOC utilizes ECON's Open Protocol Integration platform (OPI), which allows integrators to utilize either ECON's powerful CAM software for control or most major PLC control packages.



ETHERNET CONTROL SYSTEMS

INPUT / OUTPUT CONTROLLER

Specifications:

Device Control Made Easy.



General

Rack mount Dimensions (H x W x D)1.75" x 19" x 7.75"
 Panel mount Dimensions (H x W x D).....2.15" x 6.25" x 12.75"
 Rack Mount Weight.....6.2 Lbs
 Panel Mount Weight5.3 Lbs

Environmental

Storage Temperature..... -40° to 85° C (-40° to 185° F)
 Operating Temperature.....0° to 50° C (32° to 122° F)
 Storage Humidity.....5 to 85% relative humidity, non-condensing
 Operating Humidity.....5 to 85% relative humidity, non-condensing

Electrical

Rack Mount operating Input voltage90-264 VAC
 Panel Mount operating Input voltage24VDC
 Inputs8 sourcing inputs – voltage isolation 5300Vrms
 Outputs8 form C outputs – 10 Amp contact rating at 120 / 240 VAC
 Max Power consumption 45 Watts

Communications

Ethernet.....1 x 10/100 auto sensing

- Support for Hardwired TCP/IP Protocols TCP, UDP, ICMP, IPv4 ARP, IGMP, PPPoE, Ethernet
- 10BaseT/100BaseTX Ethernet PHY embedded
- Auto Negotiation (Full-duplex and half duplex)
- Auto MDI/MDIX
- ADSL connection (with support for PPPoE Protocol with PAP/CHAP Authentication mode)
- ECON OPI platform
- Supports up to 4 independent sockets simultaneously
- Internal 16Kbytes Memory for Tx/Rx Buffers
- 0.18 μm CMOS technology
- Serial Peripheral Interface(SPI MODE 0, 3) Multi-function LED outputs (TX, RX, Full/Half duplex, Collision, Link, Speed)

USB.....1 x USB 2.0 Mini-B

Wiring Summary

Each Output field wire connector includes the following:

1. Terminal 1 – Relay Common
2. Terminal 2 – N.O. Relay Contact
3. Terminal 3 – N.C. Relay Contact

Each Input field wire connector includes the following:

1. Terminal 1 – +24vdc out
2. Terminal 2 – status input

Model Numbers

ECS-3709B-RMRack mount controller
 ECS-3809B-PMPanel mount controller



ETHERNET CONTROL SYSTEMS

INPUT / OUTPUT CONTROLLER

Input / Output Controller RACK MOUNT Dimensional Drawings

Front Panel View



Rear Panel View

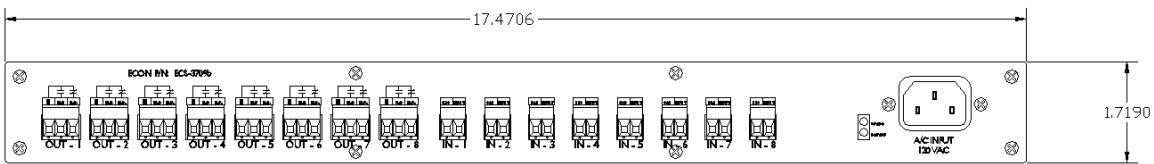

Side View

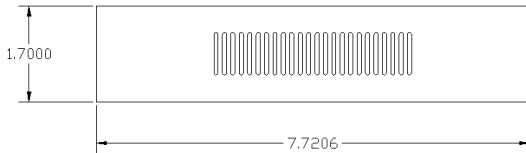

Top View

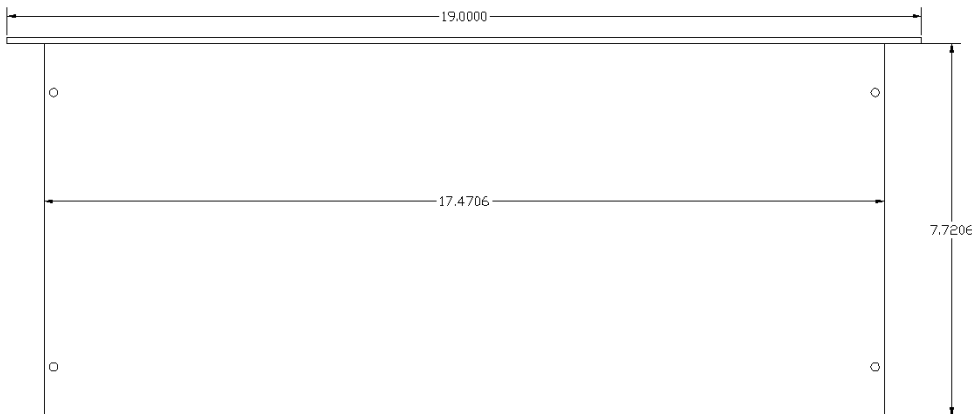



ETHERNET CONTROL SYSTEMS

INPUT / OUTPUT CONTROLLER

Input / Output Controller PANEL MOUNT Dimensional Drawings

Top View

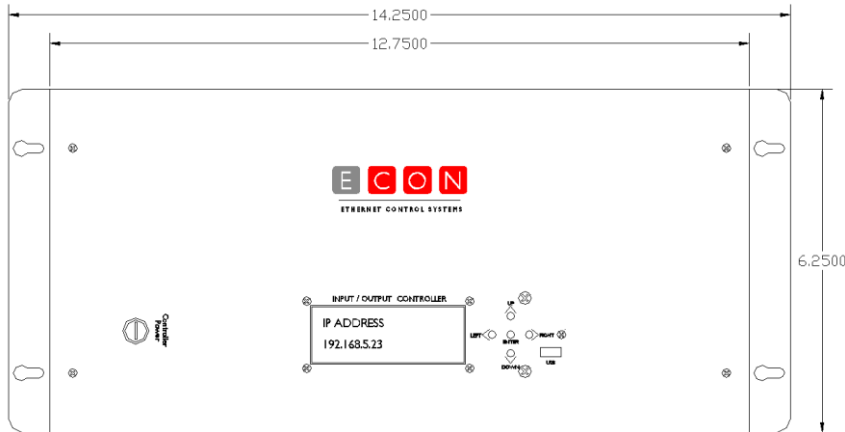

Front Panel View

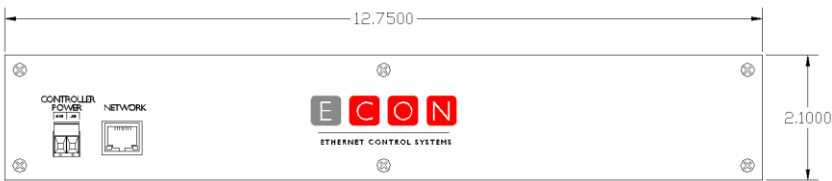

Rear Panel View

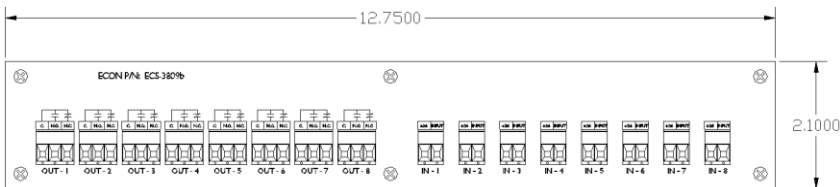

Side View

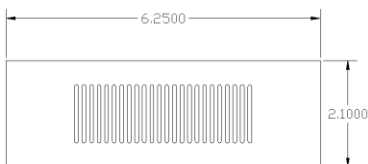

Product offerings and specifications are subject to change without notice. Actual products may vary from photos. Not all products include all features. Availability varies by region; contact your sales representative. Certain product names mentioned herein may be trade names and/or registered trademarks of other companies. © 2012 ECON Systems LLC, and its respective companies. All rights reserved